

minima
SLIDING



Cambray House





West House



minima
SLIDING



Pound Barn



minima
SLIDING



Kirkstall Road



minima
SLIDING



Vaughan House



minima
SLIDING



Rosemont





Visual Advantages

Sliding door system features market leading 20mm frame size

- Sliding door system prioritizes more view and less frame.
- System designed with integrated handle to show only 20mm of frame at sides, top, and bottom; perfectly matching the 20mm central vertical interlock.
- Electric locking system fully concealed in head frame.

Enjoy the seamless transition from inside to outside

- Our 75mm bottom frame is designed to be fully lowered for a flush track finish.
- Option for a visible cill if flush track finish not required.

Maximise your glass sizes

- Individual panels can be up to 4.2m wide or 3.2m high.
- Individual panel size cannot exceed 9m² per panel (5.4 m² for triple glazed option).

Maintain consistent frame sizes with matching fixed windows

- Large floor to ceiling fixed windows available to match sliding door profile.
- Ensures architectural coherence and uniformity.

Choose from 4 modern colours

- Polyester powder coated (PPC) colours are coated to marine grade standard (60 microns) to ensure longevity in coastal areas and beyond.
- The RAL colours are standard RAL colours and are simple to colour match with other items.
 - RAL 7016 Matt Anthracite Grey (PPC)
 - RAL 9005 Matt Jet Black (PPC)
 - RAL 7021 Matt Black Grey (PPC)
 - Brushed Platinum (Anodised)

Functional Benefits

Enjoy effortless sliding operation

- Sliding door locking system operated by an elegant wall switch.
- Stainless steel rollers and runners ensure smooth operation and rust-free performance.

Open the corner of your home

- System can provide fully opening corners at no extra cost.
- System supports different numbers of tracks meeting at sliding corners, offering architectural flexibility (for example, a triple track can meet a single track at an opening corner).

Make the most of the view with glass to glass corners

- System can be made with fixed glass to glass corners, maximising interior view and reducing frame size.

Rest assured with integrated drainage tray

- Ensures effective water drainage into external drainage channels, preventing leaks and maintaining property integrity.
- Integrated drainage tray compatible with all external drainage systems.

Add laminated glazing as necessary

- Laminated glazing upgrade is available for compliance with Part Q (Security) of building regulations if required.

Ventilate the space without creating a security risk

- Doors can be locked in a 100mm semi-open position, enabling airflow into the room while preventing unwanted entry.
- Like any frameless system, trickle vents are not available with the system and ventilation requirements are achieved by other means such as vents in other glazing or skylights, air bricks or MVHR systems.

Put safety first

- During a power cut, the electric locking system enters 'fail secure' mode, remaining locked until power is restored.
- Hidden manual override cord for unlocking from inside if necessary.

Integrate our doors into any smart home system

- Doors supplied with a Niko Home Control wall switch as standard, either for standard analogue wired use (not smart) or for integration into any smart home system.
- Integration possible at installation or at a later date.

Choose from 4 track options

- Single – 77mm
- Double – 155mm
- Triple – 232mm
- Quad – 310mm

Thermal Performance

Standard Double Glazing

| | Toughened | Laminated |
|--------------------------------|-----------|-----------|
| Ug-Value (W/m ² .K) | 1.2 | 1.2 |
| Light Transmission | 79 | 76 |
| Solar Factor (g) | 66 | 60 |

Solar Double Glazing

| | Toughened | Laminated |
|--------------------------------|-----------|-----------|
| Ug-Value (W/m ² .K) | 1.1 | 1.0 |
| Light Transmission | 70 | 69 |
| Solar Factor (g) | 38 | 38 |

Standard Triple Glazing

| | Toughened | Laminated |
|--------------------------------|-----------|-----------|
| Ug-Value (W/m ² .K) | 0.7 | 0.7 |
| Light Transmission | 62 | 62 |
| Solar Factor (g) | 42 | 42 |

Solar Triple Glazing

| | Toughened | Laminated |
|--------------------------------|-----------|-----------|
| Ug-Value (W/m ² .K) | 0.6 | 0.6 |
| Light Transmission | 62 | 62 |
| Solar Factor (g) | 31 | 31 |

Specification

| | Double Glazing | Triple Glazing |
|-----------------------------|--|--|
| Maximum panel width | 4200mm | 2700mm |
| Maximum panel height | 3200mm | 3200mm |
| Maximum panel size | 9m ² | 5.4m ² |
| Maximum panel weight | 340kg | 225kg |
| Visible frame size | 20mm top, bottom & sides | 20mm top, bottom & sides |
| Runner mechanism | Stainless steel | Stainless steel |
| Glass unit thickness | 36mm (6mm/8mm glass) | 46mm (6mm/8mm glass) |
| Sound insulation | Rw,p 33 db – 42 db | Rw,p 33 db – 42 db |
| Water tightness | 9A (EN 12208 / EN 1027) | 9A (EN 12208 / EN 1027) |
| Air permeability | C4 (EN 12207 / EN 12211) | C4 (EN 12207 / EN 12211) |
| Wind loading | C3 (EN 12210 / EN 1627) | C3 (EN 12210 / EN 1627) |
| Security rating | PAS 24 compliant (Max 7.5 m ²) | PAS 24 compliant (Max 5.4 m ²) |

Installation



minima
SLIDING

Save time and money with our industry-beating lead-times

- Continuous improvement of lead-time as well as frame first installation option where we install the frames only in around 3-5 weeks from survey.
- Overall lead-time of 6-12 weeks.

Installed by in-house installation teams

- Experienced installers fully employed by our company, operating in our vehicles, only installing our sliding doors day in, day out.
- Wide coverage of UK.

Working safely and efficiently

- Highly trained installers incentivised by safety, tidiness and customer satisfaction.
- Vast experience installing large glazed units, using a combination of vacuum suckers, glazing robots and cranes.

Benefit from our single product focus

- Exclusive focus on our UK-made sliding door.
- Highly efficient and optimised order process made possible by our focus on one product.

Standard Configurations

(Bespoke configurations available on request)

Single track



Double track

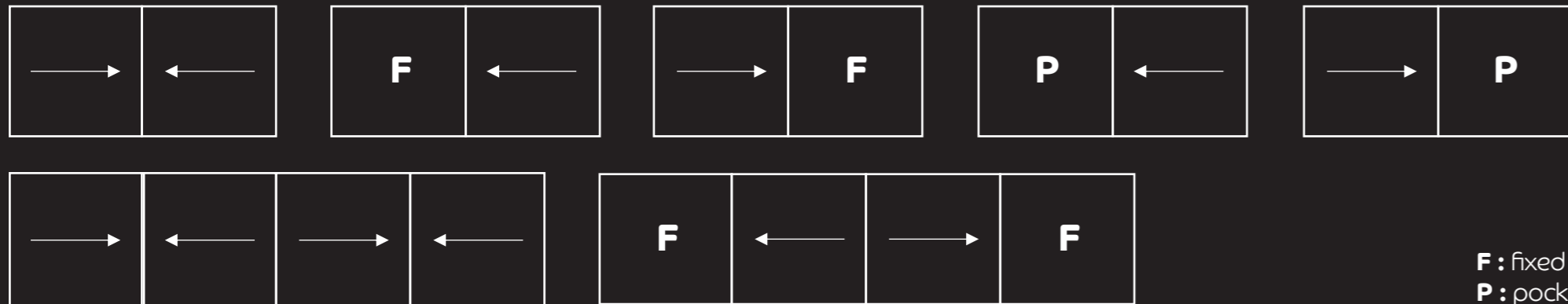

F: fixed
P: pocket

Triple track

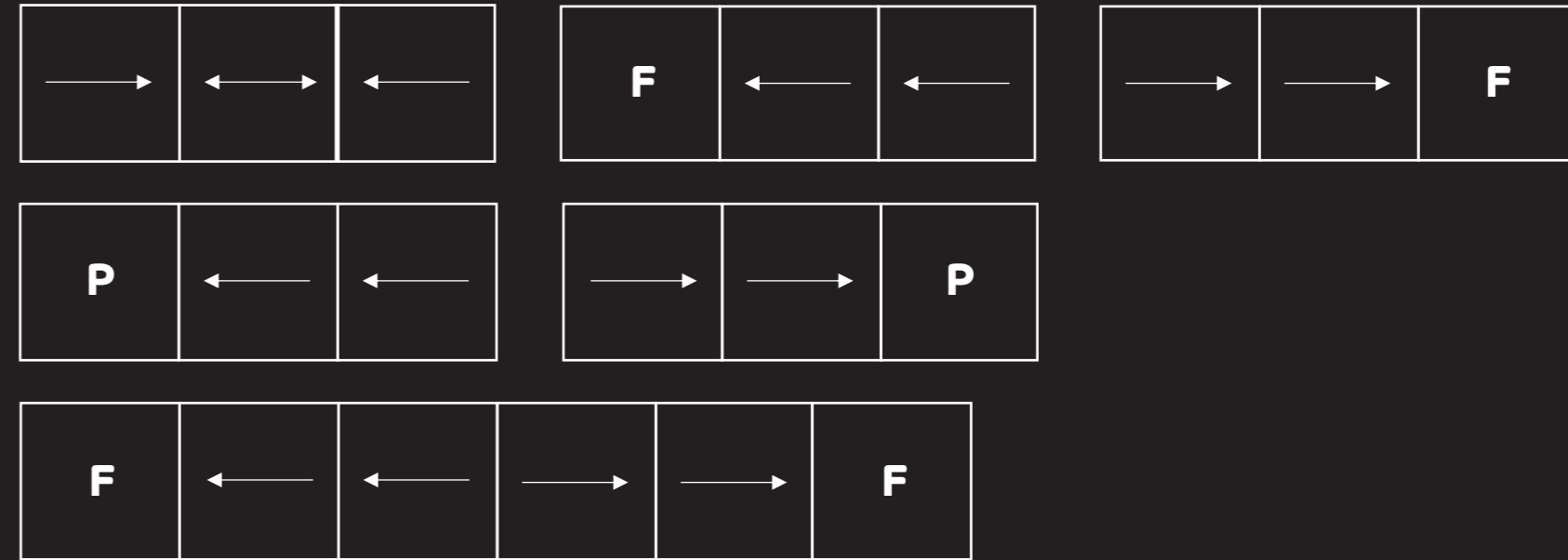

Quad track

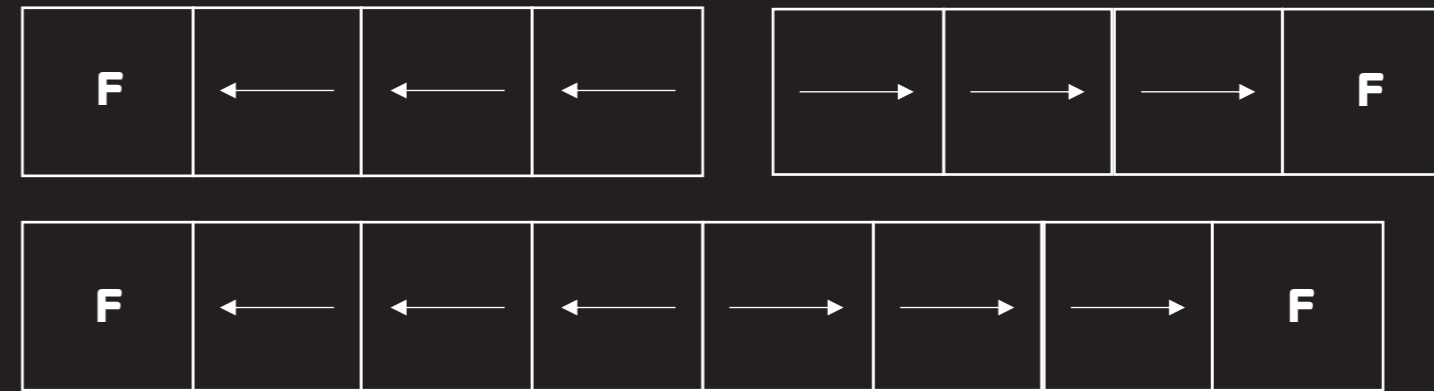

F: fixed
P: pocket

2 Track Technical Details

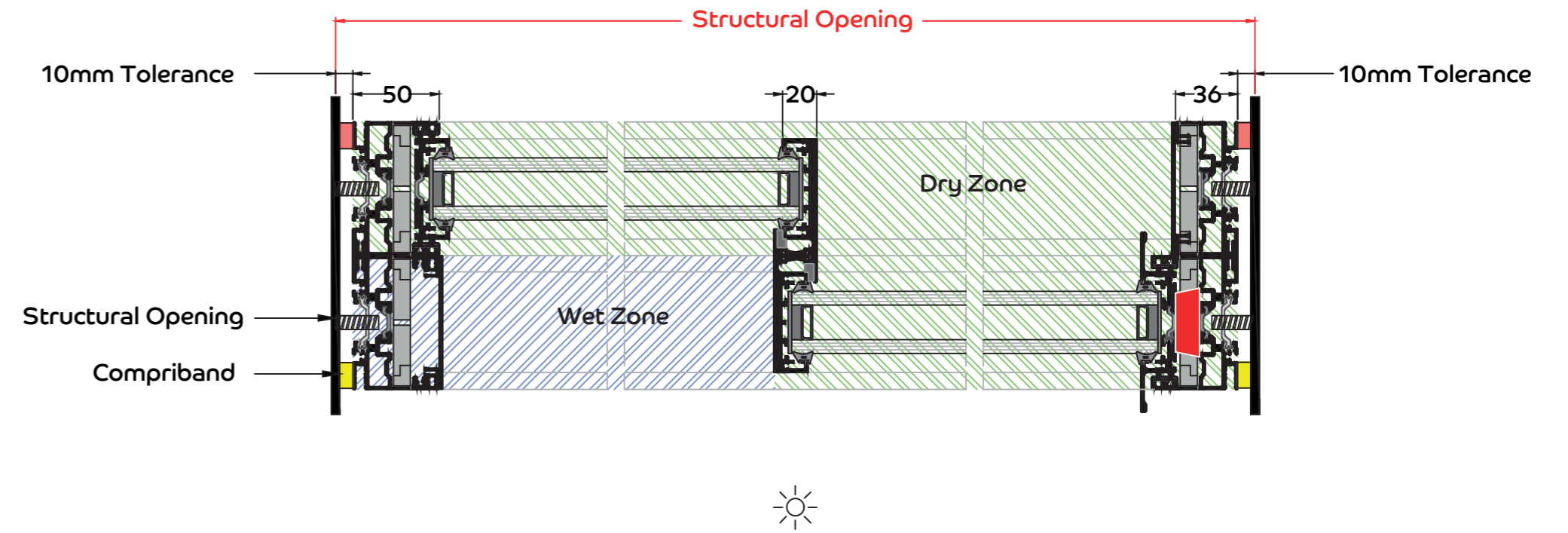
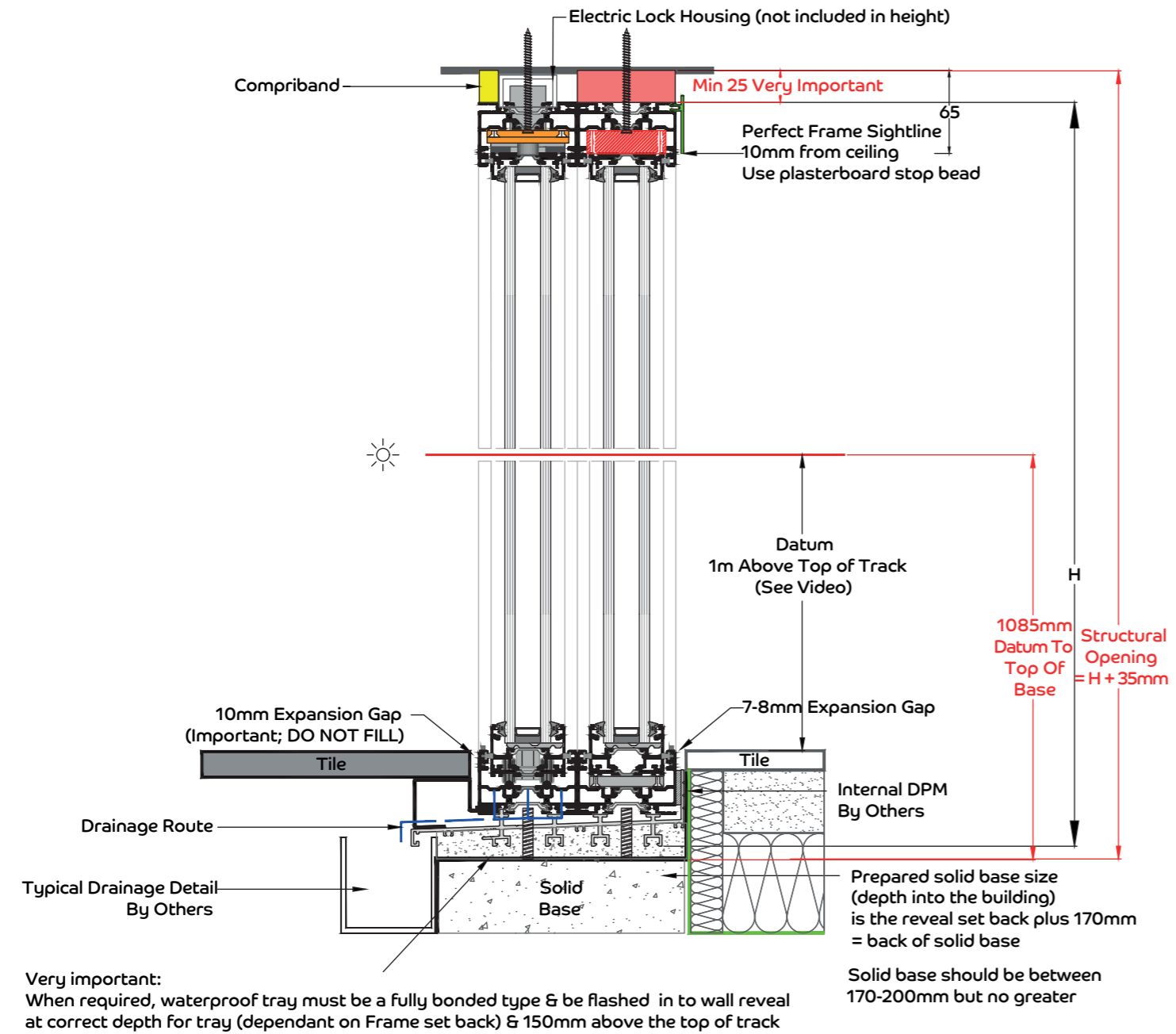

3 Track Technical Details

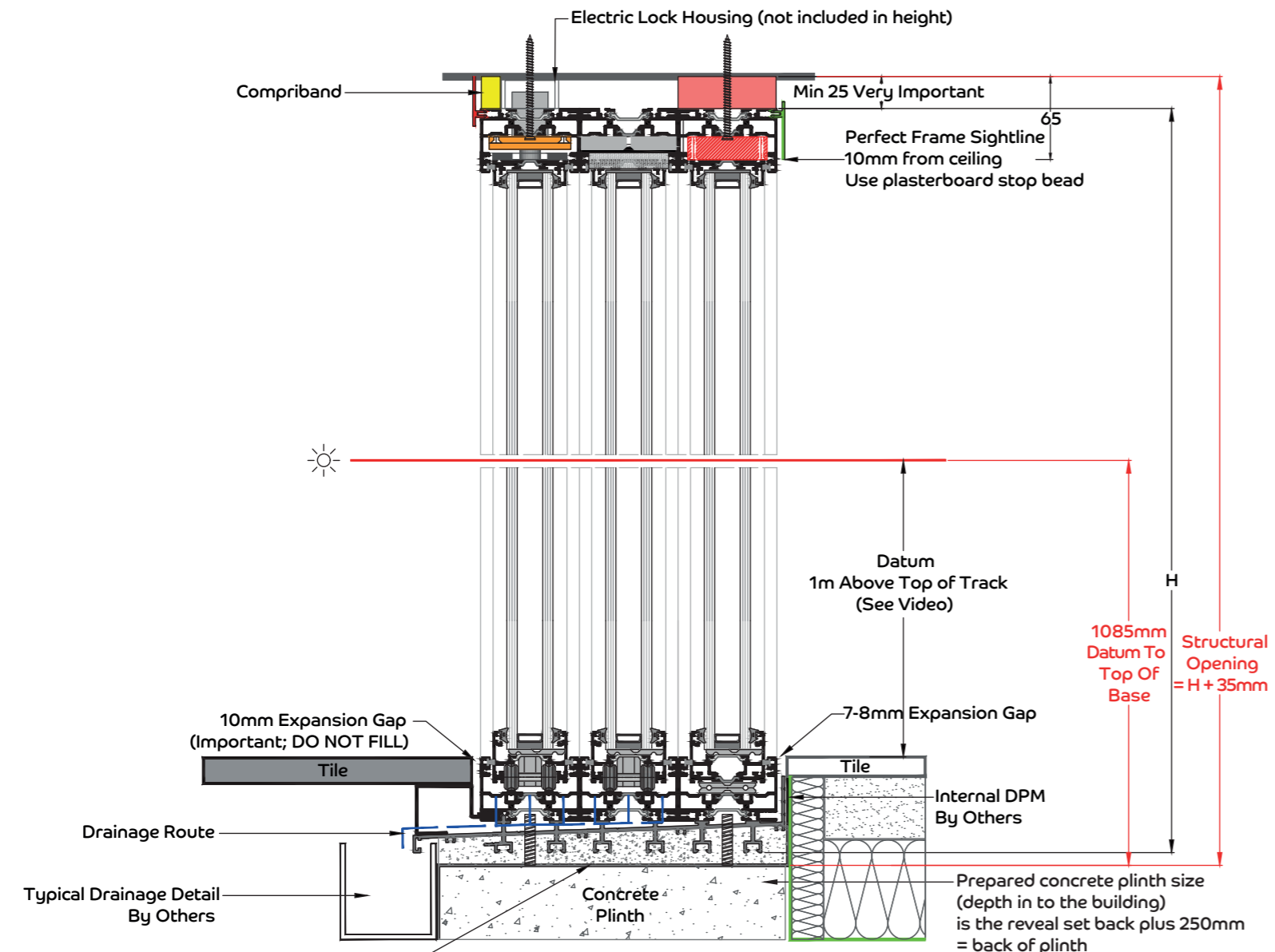

Very important:
When required, waterproof tray must be a fully bonded type & be flashed in to wall reveal at correct depth for tray (dependant on Frame set back) & 250mm above the top of track

Concrete plinth should be between 250-280mm but no greater

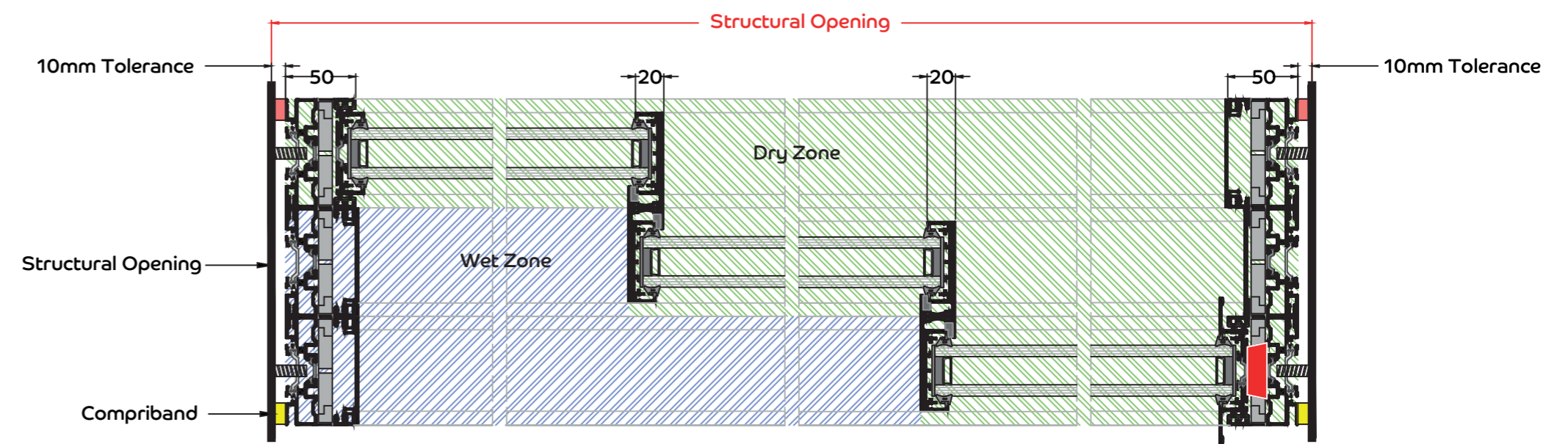



Meet The Team



Anne-Celine Smith
Finance & Marketing Director



James Day
Sales Director



Dan Smith
Operations Director



Andy Wakeman
Business Dev Manager



Georgia Smith
Sales



Esther Jenner
Accounts Manager



David Beckwith
Installation Manager



Jack Goldup
Asst. Installation Manager



Harry Beckwith
Installation Team Leader



Liam Grey
Installation Engineer



Toby Collis
Installation Engineer



Rupesh Pun
Installation Engineer



The Hollies





Dulwich Row



minima
SLIDING



minima
SLIDING



Larch House

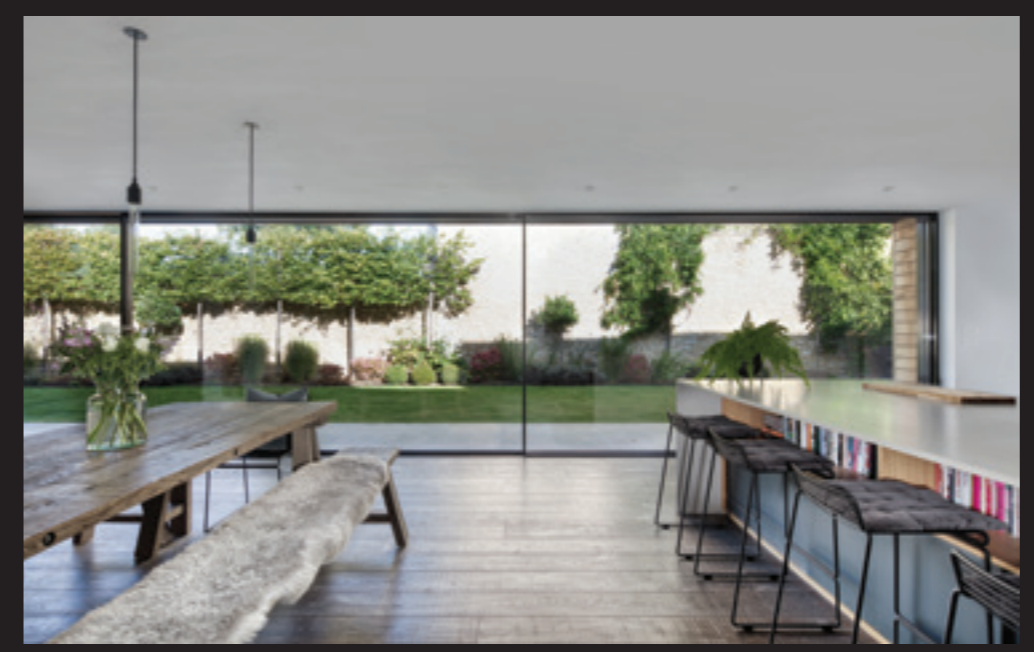



The Boathouse





Woodlands Park



minima

SLIDING

Minima Sliding

Unit 4 Adams Wharf, Branbridges Road, East Peckham, Kent, TN12 5EJ

E: enquiries@minimasliding.co.uk **T:** 01622 902 095

W: minimasliding.co.uk